

Quick Start Guide

D3 Series

Version: 1.5

Overview

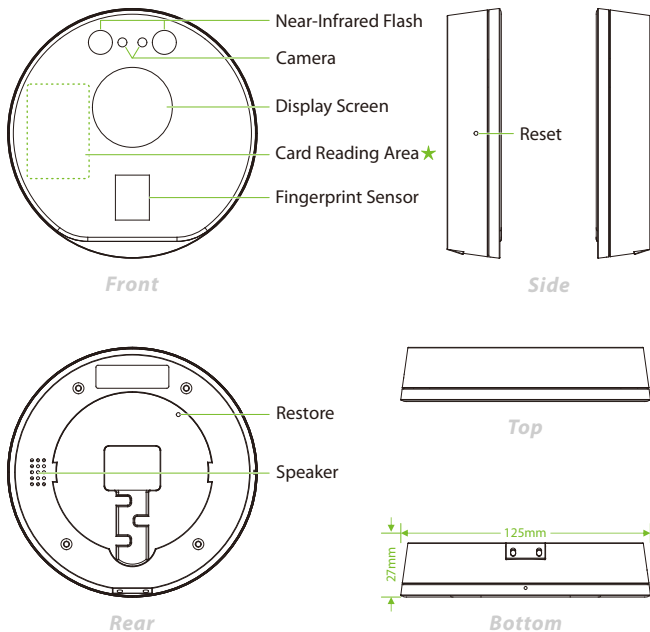

Note: Not all products have the function with ★, the real product shall prevail.

Terminal Block

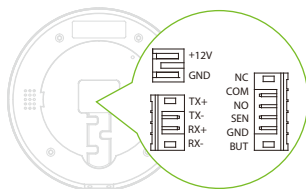

Interface	Description
	Power In
	Network Interface
	Access Control

Standalone Installation

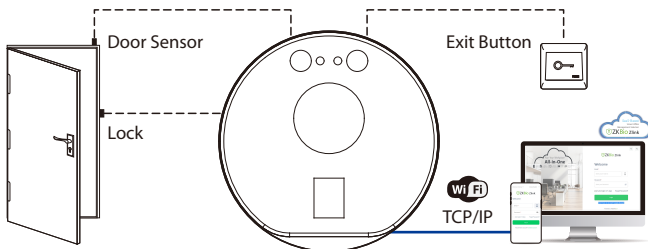

Note:

1. Make sure that the device and the PC have access to the external network before using ZKBio Zlink to bind them.
2. After successfully binding the device to ZKBio Zlink, the standby screen will display the current IP address for 30 seconds every time it is powered.

Installation Environment

Please refer to the following recommendations for installation:



INSTALL INDOORS
ONLY



AVOID GLASS
REFRACTION



AVOID DIRECT
SUNLIGHT
AND EXPOSURE



KEEP EFFECTIVE
DISTANCE
0.3 to 1.6m

Power Connection

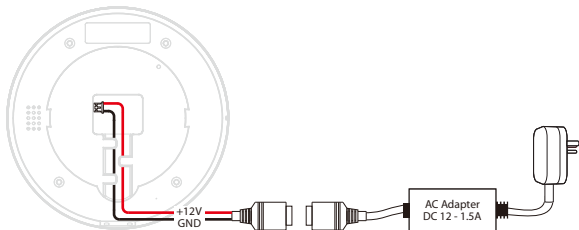

1. $12V \pm 10\%$, at least 1500mA.
2. To share the power with other devices, use an AC Adapter with higher current ratings.

Door Sensor and Exit Button Connection

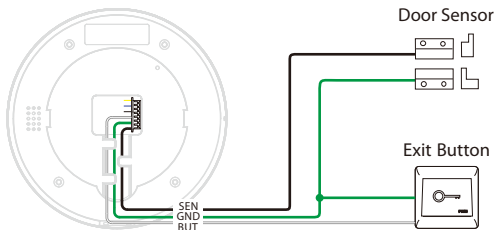

Lock Relay Connection

The system supports **Normally Opened Lock** and **Normally Closed Lock**. The **NO LOCK** (normally unlocked when power-on) is connected with '**NO**' and '**COM**' terminals whereas the **NC LOCK** (normally locked when power-on) is connected with '**NC**' and '**COM**' terminals. Take NC Lock as an example below:

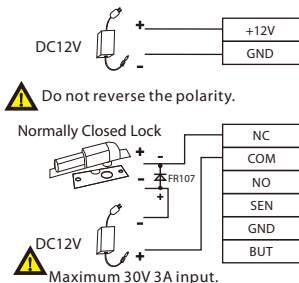

Configuring the Network via Bluetooth

After creating a ZKBio Zlink App account (see the user manual for details), follow the steps below to add the device and configure the network for the device.

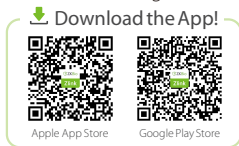

Add Device:

1. Log in to the ZKBio Zlink APP with the account you have already created.
2. Click **[Applications]** > **[CloudATT]** > **[Device]** to enter the Device add screen.
3. Click **+** icon to add a new device. Review the instructions and click **[Continue]**.
4. Then click **[Use bluetooth to add device]** > **[Rescan Bluetooth device]** to search for the device via Bluetooth. And the searched Bluetooth devices will be displayed in the list.
5. Then just select the device you want to add based on the serial number.

Configuring the Network via Bluetooth:

1. Once the device is selected, you will enter the Network Configuration interface.
2. Select a Wi-Fi in the list and enter the password to connect. When the interface prompts **"Device Connected to Network Successfully"**, it means the connection is successful.
3. Then specify the device to a site and zone. Enter the parameters and click **[OK]**, when prompted successfully, the configuration is complete.
4. The added devices will be displayed in the Dashboard and Device module.

Note:

1. Turn on your smartphone's Bluetooth and location functions before powering up the device.
2. The device must be near the phone to avoid search failures.
3. The device can only connect to 2.4GHz Wi-Fi networks. Make sure that your phone is connected to the 2.4GHz network.

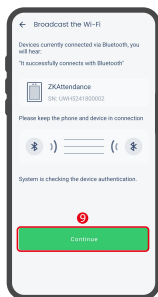
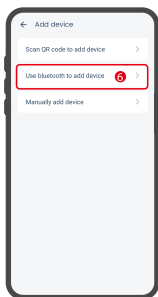
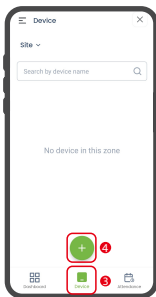
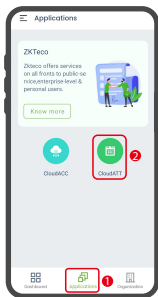

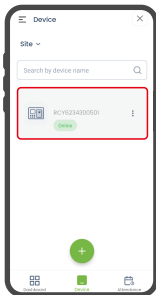
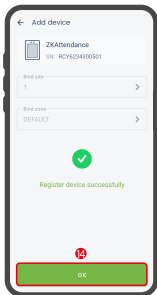
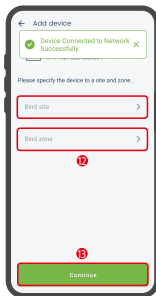

Connecting to ZKBio Zlink Web

After successfully adding devices using the ZKBio Zlink App, you can use the created account to access ZKBio Zlink Web to find devices, add new personnel, register the verification method of registered personnel, synchronize personnel to devices and query records. Access the ZKBio Zlink Web <https://zlink.minervaiot.com/>.

The image displays the ZKBio Zlink Web interface, divided into two main sections: the login page and the dashboard.

Login Page:

- Header:** "Run Your Workplace All-in-One" with icons for Sound Control, Motor Management, Time & Attendance, In-App Guide, and Online Technical Support.
- Logo:** ZKBio Zlink logo.
- Welcome:** A greeting message.
- Form Fields:**
 - Email *:** "Enter your E-mail ID" (marked with a red 1).
 - Password *:** "Enter your Password" (marked with a red 1).
 - ☐ Auto login in 5 days
 - [Forgot Password?](#)
- Sign In:** A green button (marked with a red 2) with a mouse cursor clicking it. A green callout bubble points to the form fields with the text: "Enter the account and password you have created".
- Footer:** "Not yet have account? Sign up"

Dashboard:

- Header:** ZKBio Zlink logo, user profile "Test 123", and language "In Java".
- Left Sidebar:** Dashboard (selected), Contacts, Applications, Site, Operation Log.
- Main Content:**
 - Dashboard:** Overview of system metrics.
 - Personnel:** 2 Total Number of Personnel (with a person icon).
 - Stops:** 2 Total Number of Stops (with a clock icon).
 - Devices:** 1 Total Number of Devices (with a device icon).
 - Device Status:** 1 Device
 - Device 1: Status: ONLINE (green dot).
 - Filters:** All Sites, All Zones.

Add Person on the ZKBio Zlink Web:

1. Click **[Me]** > **[Organization]** on the ZKBio Zlink Web main menu to add person.

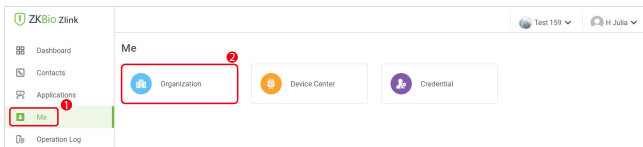

2. Click **+** icon to add a new person. Then enter the person's information, and click **[Add]**.

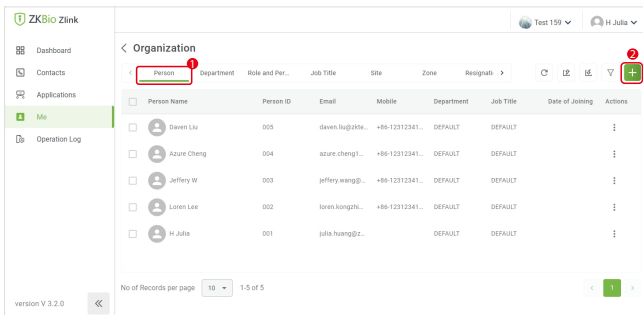

Note: It is also possible to add persons to the App via path **[Organization]** > **[Person]** > **+** icon.

Synchronize Persons to Device:

1. Click **[Applications]** > **[CloudATT]** to enter the CloudATT setting screen.

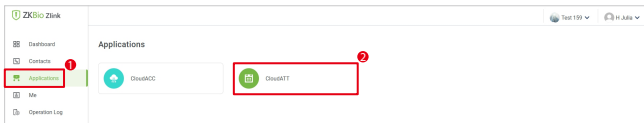

2. Click **[Device]** and select the device you want to synchronize people with, click the **:** icon after it and select **[Person in device]**.

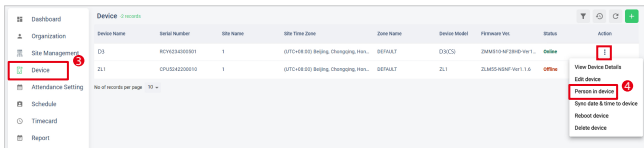

3. Then click add icon **+** to choose persons to synchronize to this device.

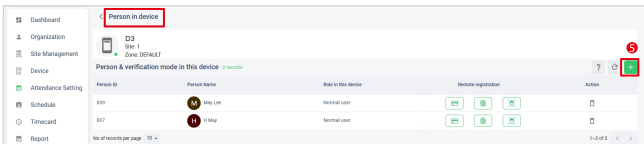

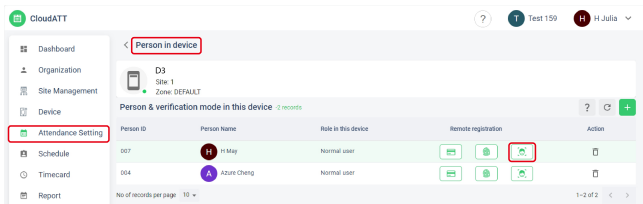

Registering Face and Fingerprint on the ZKBio Zlink Web:

1. After the successfully synchronizing persons to device, you can view the basic information in the **[Person in device]** interface.

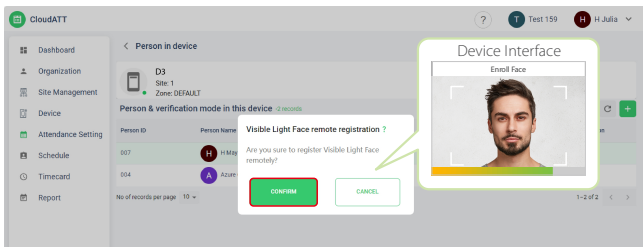

2. Click  icon to register Visible Light Face remotely. Click **[CONFIRM]** to confirm. Then follow the prompts to enter your face on the device side.



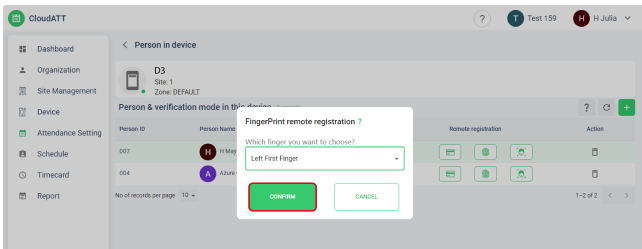
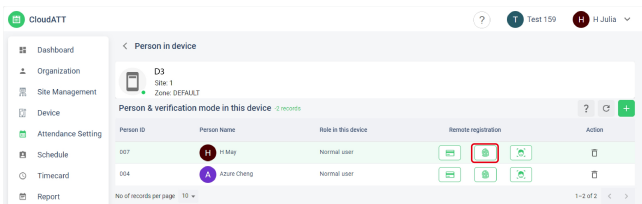

3. Click  icon to register Fingerprint. Select the finger to be recorded, click **[CONFIRM]** to confirm. and then follow the voice prompts to record the fingerprint on the device side.



Note: The registration of the card number is the same, D3 series does not support the password method.

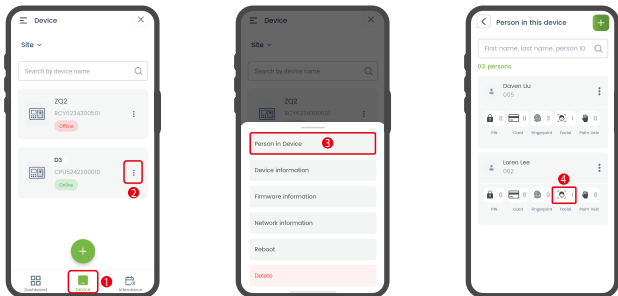

Registering Face on the App

1. Log in to the App and click **[Applications]** > **[CloudATT]** > **[Device]** to enter the Device screen.
2. Click the  icon behind the device and select **Person in Device** in the pop-up menu.
3. Then click the  icon of the person whose face needs to be registered. At the same time, the device voice prompts **"Please look straight to the camera"**.
4. Operate according to the prompts, when you hear the device prompts **"Registration is successful"**, it means that the face registration is successful.



Please refer to the User Manual for more details.

Registering Fingerprint on the App

1. Log in to the App and click **[Applications]** > **[CloudATT]** > **[Device]** to enter the Device screen.
2. Click the  icon behind the device and select **Person in Device** in the pop-up menu.
3. Then click on the  icon and select the fingerprint to be enrolled in the pop-up window. Click **[Submit]** to confirm.
4. At the same time, the device voice prompts **"Please press your finger"** and press three times on the collector after hearing the prompt.
5. When you hear the message **"Registration is successful"**, the registration is successful. And you can repeat the above operation to register other fingers.

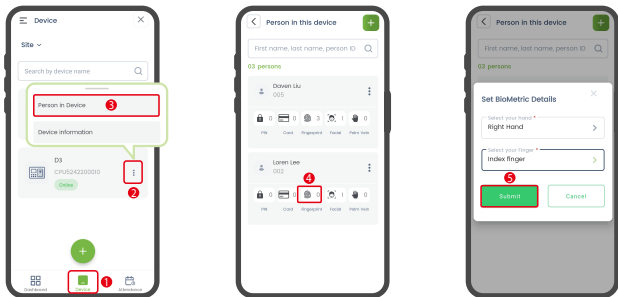

Please refer to the User Manual for more details.

ZKTeco Industrial Park, No. 32, Industrial Road,
Tangxia Town, Dongguan, China.

Phone : +86 769 - 82109991

Fax : +86 755 - 89602394

www.zkteco.com

