

# Quick Start Guide

---

## SpeedFace-V4L Pro Series

Version: 1.0

# 1 Overview

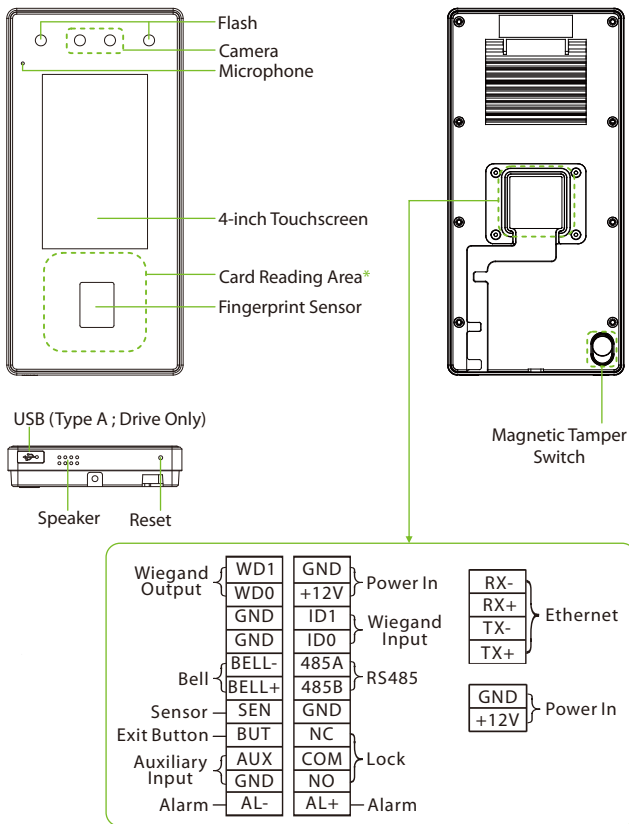

## Note:

- To ensure the accuracy of fingerprint recognition, please remove the fingerprint sensor protective film before using your fingerprint.
- Not all products have the function with \*, the real product shall prevail.

## 2 Installation Environment

Please refer to the following recommendations for installation:



INSTALL INDOORS  
ONLY



AVOID INSTALLATION  
NEAR  
GLASS WINDOWS



AVOID DIRECT  
SUNLIGHT  
AND EXPOSURE



AVOID USE OF ANY  
HEAT SOURCE  
NEAR THE DEVICE

- Avoid direct contact to sunlight for a long time.
- Protect the device from moisture, water, and rain.
- Handle the device with care.
- Make sure that the device is not installed in close proximity to a sea or other environments where metal oxidation and rust may occur if the device is exposed for a long time.
- Protect the device from lightning.
- Make sure that the device is not working in an acidic or alkaline environment for a long time.

## 3 Standalone Installation

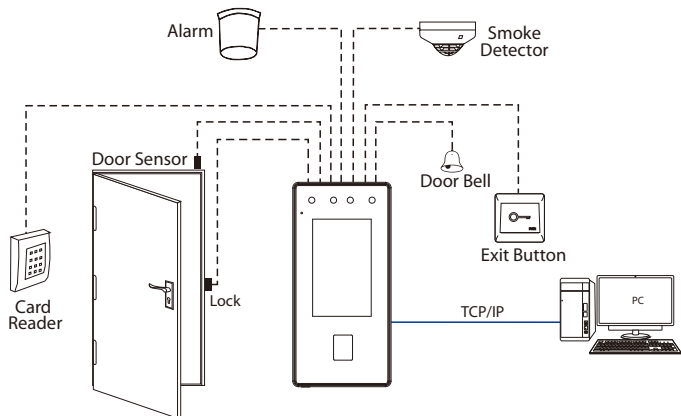

## 4 Door Bell, Exit Button and Alarm Connection

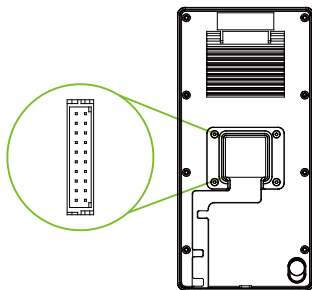
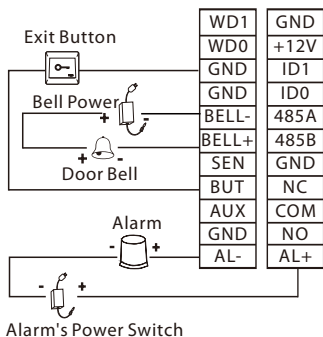

## 5 Door Sensor and Smoke Detection Connection

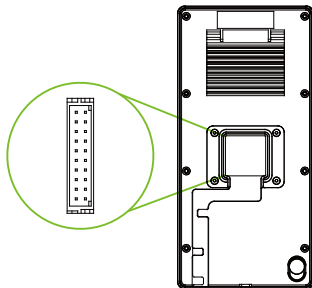
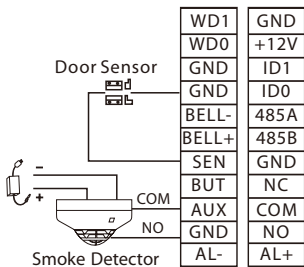

## 6 Power Connection

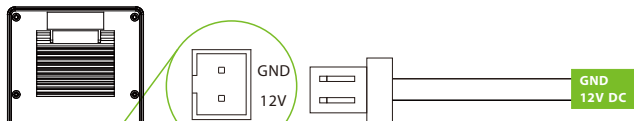

### Recommended Power Supply:

- 12V  $\pm$  10%, at least 3000mA.
- To share power with other devices, use a power supply with higher current ratings.

## 7 RS485 and Wiegand Connection

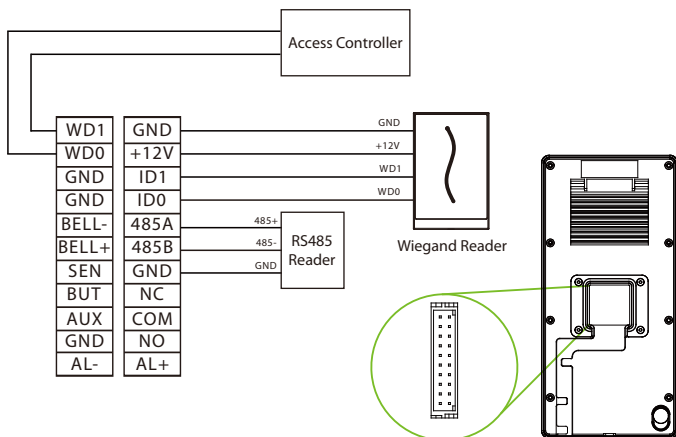

## 8 Ethernet Connection

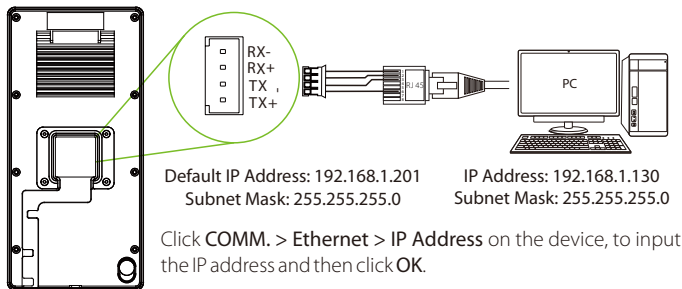

## 9 Lock Relay Connection

The system supports Normally Opened Lock and Normally Closed Lock.

The NO LOCK (Normally opened at Power On) is connected with "NO1" and "COM" terminals, and the NC LOCK (Normally closed at Power On) is connected with "NC1" and "COM" terminals. Take NC Lock as an example below:

Device not sharing power with the lock:

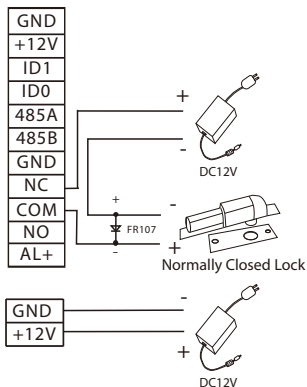

Device sharing power with the lock:

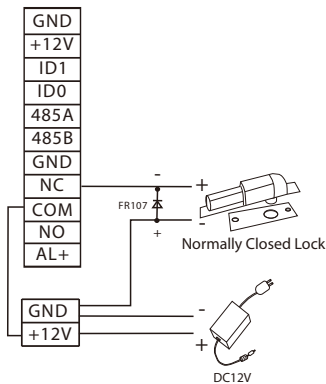

# 10 User Registration

When there is no super administrator set in the device, click on  to enter the menu. Add a new user, set their User Role to Super Admin, and the system will request administrator verification before granting access to the menu. It is strongly recommended to register a super administrator initially for security purposes.

## Method 1: Register on the Device

Click on  > **User Mgt.** > **New User** to register a new user. The options include entering the User ID and Name, Setting User Role, Registering Fingerprint, Face, Card Number\*, Password and Adding Profile Photo.

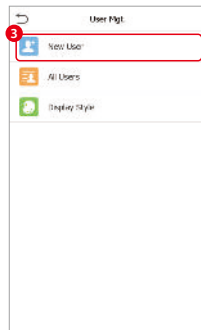
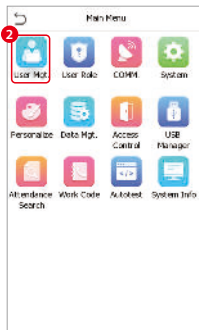
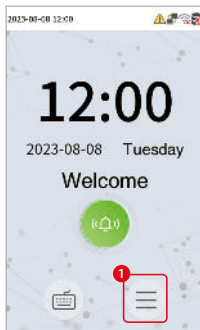

New User	
User ID	2
Name	
User Role	Normal User
Fingerprint	0
Face	0
Card	0
Password	
Profile Photo	0
Access Control Role	



## Method 2: Register on ZKBio CVAccess Software

### ● Register on the PC

Please set the IP address and cloud service server address, in the Comm. Menu option on the device.

1. Click **Access > Access Device > Device > Search** to search the device on the software. When an appropriate server address and port are set on the device, the searched devices are displayed automatically.

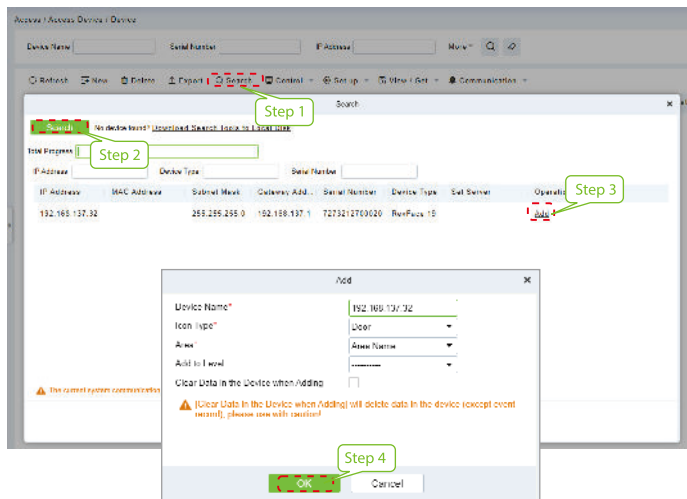

2. Click **Add** in an operation column, a new window will pop-up. Select Icon type, Area, and Add to Level from each dropdowns and click **OK** to add the device.
3. Click **Personnel > Person > New** and fill in all the required fields to register new users in the software.
4. Click **Access > Device > Control > Synchronize All Data to Devices** to synchronize all the data into the device including the new users.

For more details, please refer to the *ZKBio CVAccess User Manual*.



## ● Register on the Phone

Once the ZKBio CVAccess software is installed, the users could enroll their face template via a browser application on their own mobile phone.

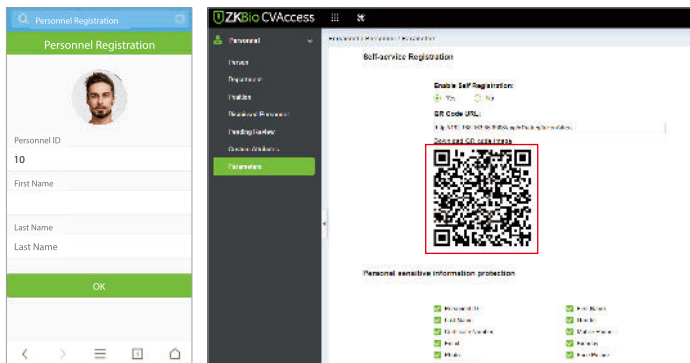

1. Click **Personnel > Parameters**, input "http://Server address:Port" in the QR Code URL. The software will automatically generate a QR code. To register users, scan the QR code or log in at 'http://ServerAddress:Port/app/v1/adreg' using a mobile phone.



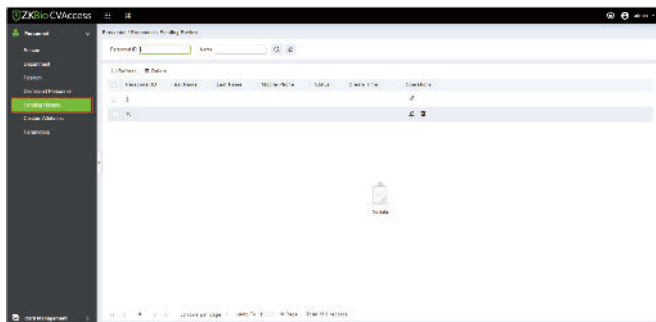

2. The users will be displayed in **Personnel > Pending Review**.



# 11 Ethernet and Cloud Server Settings

Click on  > **COMM.** > **Ethernet** to set the network parameters. If the TCP/IP communication of the device is successful, the icon  will be displayed in the upper right corner of the standby interface.

Click on  > **COMM.** > **Cloud Server Settings** to set the server address. If the device communicates with the server successfully, the icon  will be displayed in the upper right corner of the standby interface.

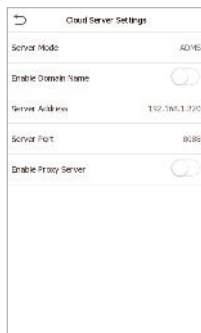
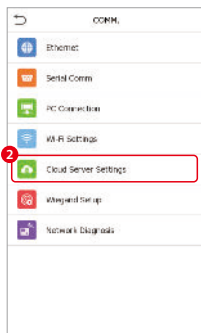
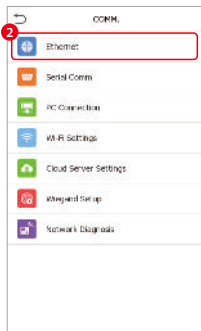
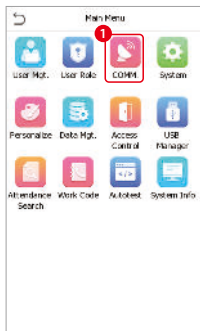

## 12 Connecting to ZKBio Zlink App

Click on ☰ > **System** > **Device Type Setting** to change the device communication protocol to the BEST protocol, the device can then be managed by ZKBio Zlink.

### Step 1: Download the App

Search for the **ZKBio Zlink** App in Apple App Store or Google Play Store and download the App into your smartphone.



### Step 2: Create Your Account

Open the **ZKBio Zlink** App and create an account with your phone number or an Email ID.

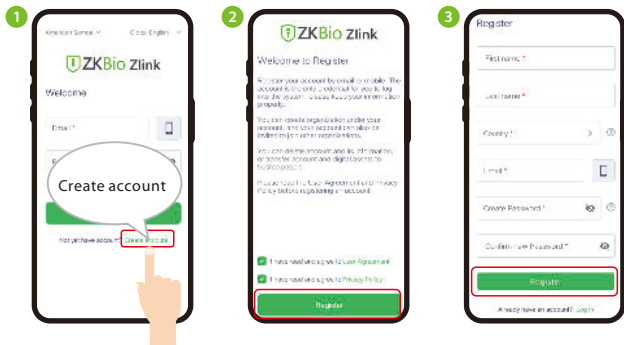

### Step 3: Create the Organization

Log in with your successfully registered account and follow the page prompts to create an organization.

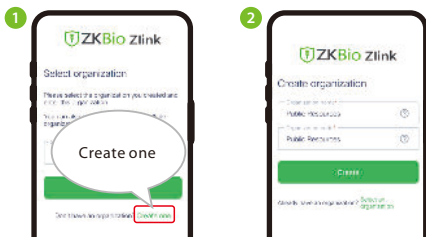

### Step 4: Add the Site and Zone

Log in with your created account and organization. After a successful login, add **Site** and **Zone** in the **Me** interface.

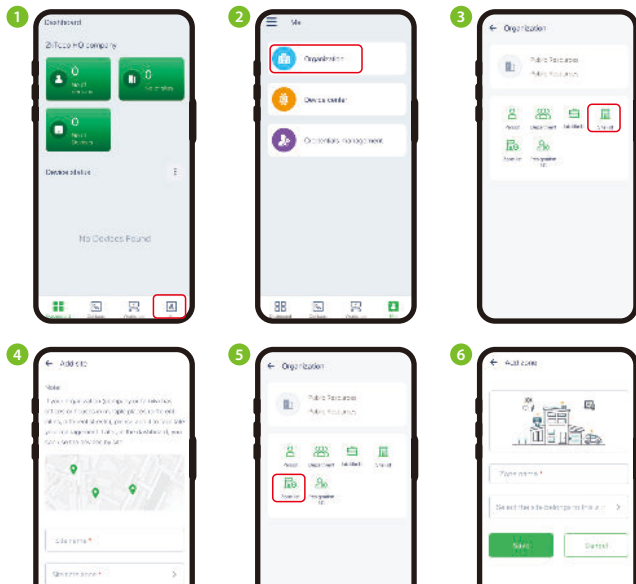

## Step 5: Binding the Device

In Workshop interface, click CloudACC > Me > Device List to add devices.

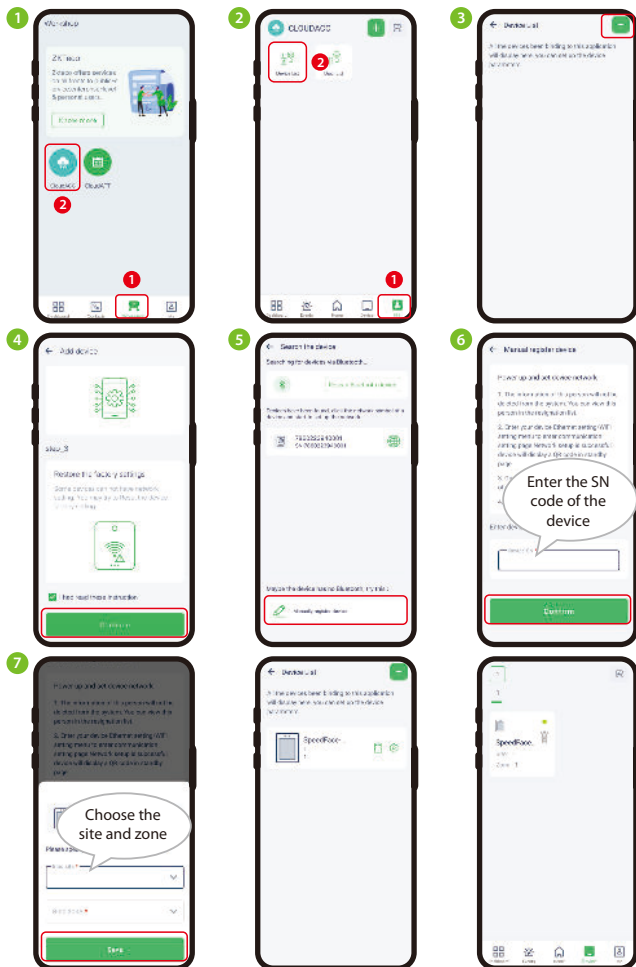

## 13 Connecting to ZKBio Zlink Web

After successfully adding devices using the ZKBio Zlink App, you can use the created account to access the ZKBio Zlink Web. With this web interface, you can find devices, add new personnel, register verification methods for registered personnel, synchronize personnel to devices, and query records. To access the ZKBio Zlink Web, please visit <https://zlink.minervaiot.com/>.

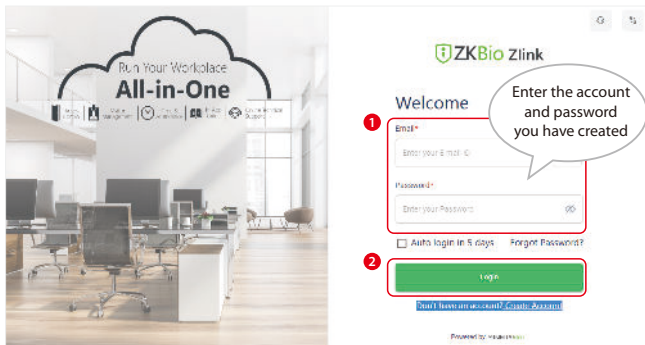

### Add Person:

1. Click **Me > Organization** on the ZKBio Zlink Web main menu to add a person.

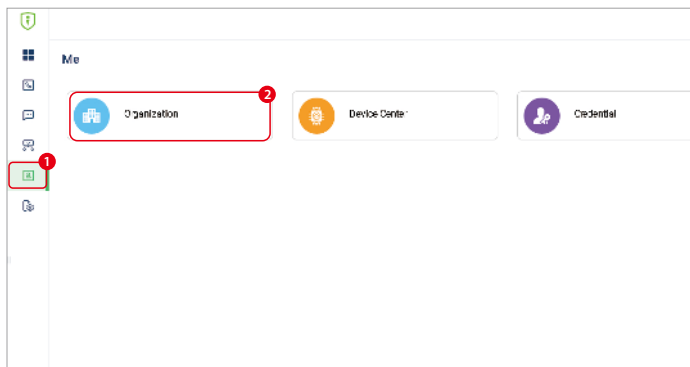

- Click add icon  to add a new person. Enter the person's information, and click **Save**.

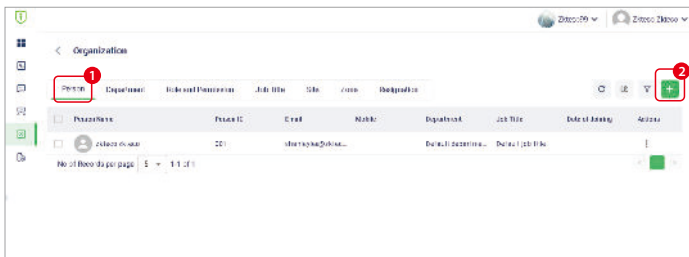

## Synchronize Persons to Device:

- Click **Workshop** > **CloudACC** on the ZKBio Zlink Web main menu.

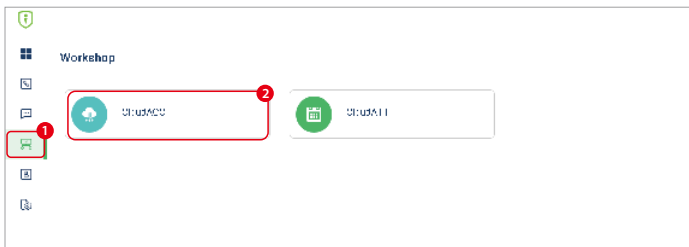

- Click **Access Control** > **Group Access Time** > **Manage Door** icon  to choose the device.

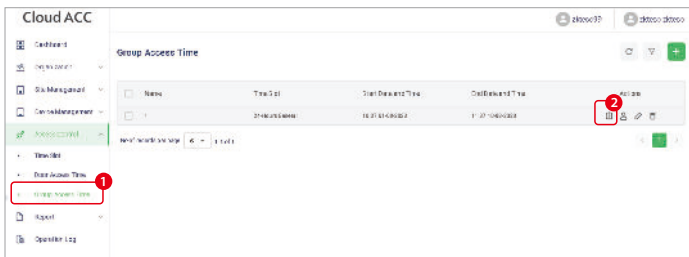

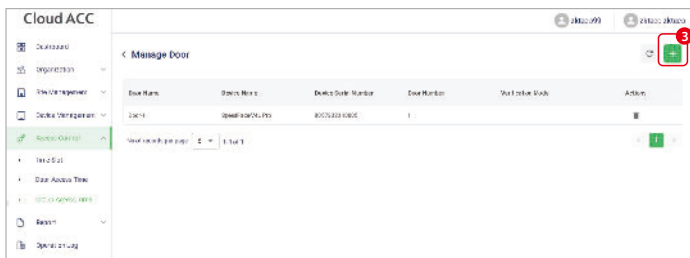

3. Click **Access Control > Group Access Time > Manage Person** icon  to choose persons for synchronization to this device.

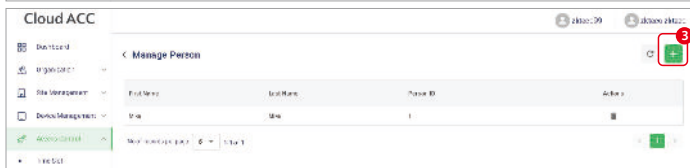





## Register Verification Mode:

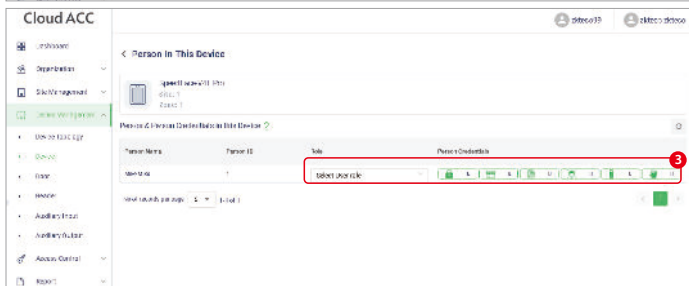
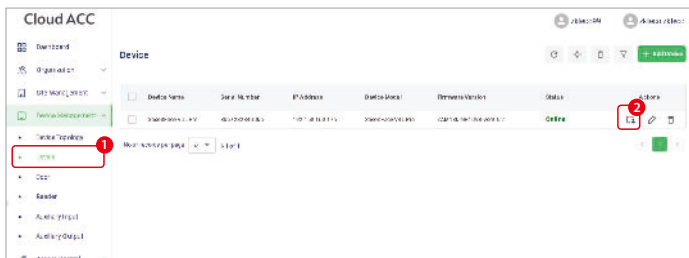

After successfully synchronizing persons to the device, you can view their basic information in the **Person in the device** interface. Click **Workshop > CloudACC > Device Management > Device > Persons in the Device** icon , click the relevant biometric function icon (Fingerprint/Face/Password/Card) to remotely register the Personnel Biometric Identification Method.



**Note:** SpeedFace-V4L Pro Series does not support the palm verification method.

## 14 Connect the Wireless Doorbell★

This function needs to be used with the wireless doorbell.

First, power on the wireless doorbell. Then, press and hold the music button  for 1.5 seconds until the indicator flashes to indicate it's in pairing mode. After that, click on the SpeedFace-V4L Pro icon , if the wireless doorbell rings and the indicator flashes, it means the connection is successful.

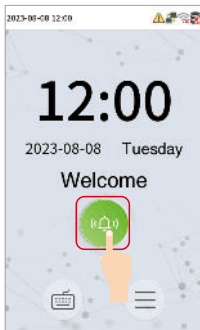

SpeedFace-V4L Pro

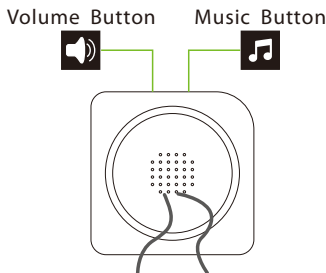

Wireless Doorbell

After a successful pairing, clicking the  icon of SpeedFace-V4L Pro will ring the wireless doorbell.

**Note:** Generally, each SpeedFace-V4L Pro connects to 1 wireless doorbell.

ZKTeco Industrial Park, No. 32, Industrial Road,  
Tangxia Town, Dongguan, China.

Phone : +86 769 - 82109991

Fax : +86 755 - 89602394

[www.zkteco.com](http://www.zkteco.com)

